

# ASSEMBLY AND INSTRUCTION MANUAL

## MODEL 6011 LEA

© 2013 KURT BEIER & KATI QUINGER



AS AN ADDITIONAL OPTION  
A HANG OVER CUSHION



SLIP COVER WITH ZIPPER



SLIP COVER WITH BOX PLEAT

## Assembly manual

---

### Information

---

**ATTENTION!** To ensure secure assembly, please observe the individual steps of instruction!

The furniture should always be mounted in pairs (2 persons)!

### CONTENTS

---

- 2 side panels, 1 foot part (semi-product)
- 1 headboard (completely upholstered)
- 1 loose slip cover for corpus of bed
- 40 hexagon socket countersunk screws
- 4 corner connectors (2 x left, 2 x right)
- 1 beech wood centre support rail with angle connectors
- 1 Allen key, size: 4 mm

#### Use of slatted frame:

- 4 slatted frame angles for corner connectors
- 2 slatted frame angles for side panels,
- 4 wooden feet
- 1 plastic foot (120-235 mm)

#### Use of box spring system:

- 5 plastic glides (25 mm)
- 1 plastic supporting foot (44-73 mm)
- 1 plastic supporting foot (89-125 mm)

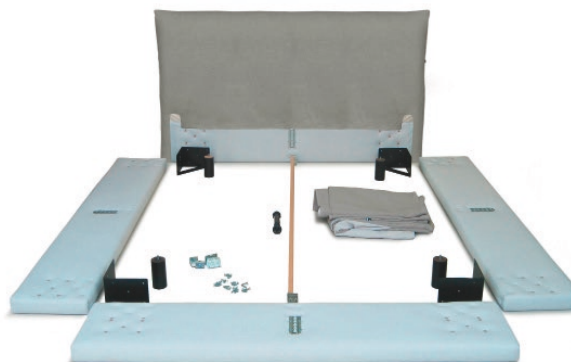

1. Unpack the individual parts of the bed, place them as shown at picture and check the delivered package contents for completeness.

2. For assembly of bed, headboard and foot part or rather the 2 side panels should be placed at opposite side, and their zipper to the center (or in upright position towards floor). The bores should point upwards/inwards. The blocked holes are only for the use of box spring systems. By the use of box spring system, unscrew the plastic screws and screw them in the upper holes.

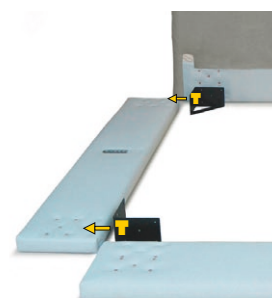

3. Position the connector angles with the T-shaped punch-outs in direction to side panels. Mount 2 angles at headboard and 2 angles at the ends of side panels. Place screws carefully and tighten them with an Allen key.

**ATTENTION!**  
There are right and left angles.

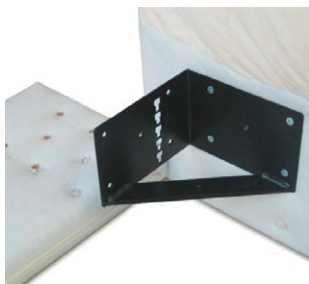

4. Set up one of the side panels and position it at angle. First of all, place 2 outer screws and slightly tighten them. Now it will be easier to place the other screws. Revise these steps with the other side panel.

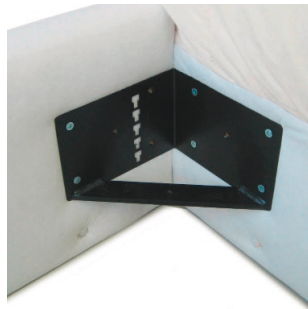

5. Next position the foot part and screw it as pictured at point 4.



6. Slatted frame: screw the 4 wooden feet in the tapped holes of connector angles.

Box spring system: plug in the plastic gliders in the hole beside the tapped hole.



7. Slatted frame: take the large support foot and press it from below in the hole of the centre support rail. Box spring system: use one of the smaller support feet, depending on the height you decided to adjust. Use the small support foot for the 2 lower, the medium for the upper attachment points.

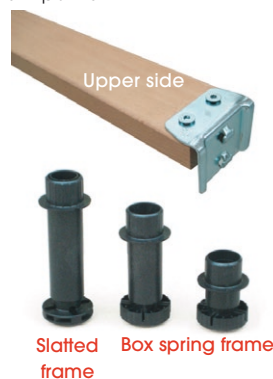

8. Mount the centre support rail at connectors of headboard and foot part at the desired height and adjust the support foot at floor level. First connect headboard. If the centre support rail is difficult to mount, slightly loose the screws of corner angles at foot part. After connecting of centre support rail tighten the screws again.



9. Mount slatted frame angles at corner angles and the 2 side panels at desired height.



Angles of side panels (fig. above).  
The insert depth for slatted frame is height adjustable: approx. 12,5-22 cm.



10. Place slip cover (with velcro part inwards) onto corpus of bed.  
(Do not yet remove the soft side strap of velcro!)

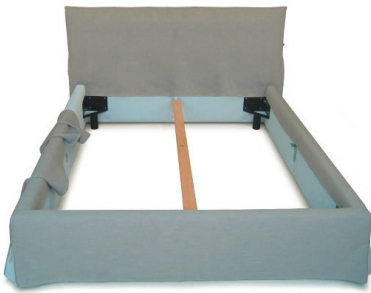

11. Pay attention that the corner seams are exactly oriented at mitre and the parts of box pleat hang down exactly at the 2 edges in front.



12. After you have placed the cover properly onto the corpus, remove the velcro (soft side strap) carefully and fix the cover.



13. Cover with zipper: it is possible to open/close the zipper at headboard/foot part as desired.

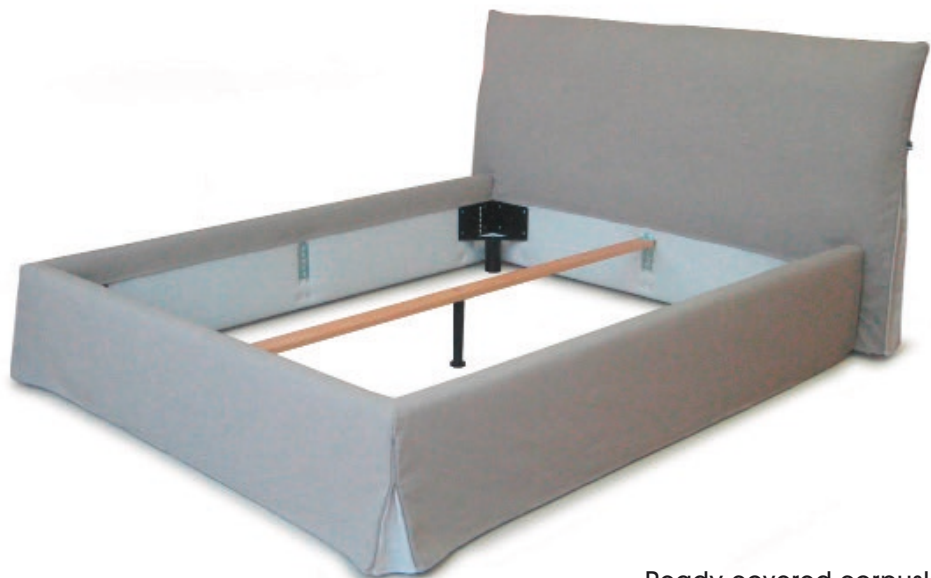
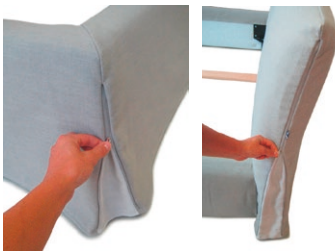

Ready covered corpus!



Detailed assembly instruction of slatted frames:

Insert depth for slatted frame = 12,5-22 cm

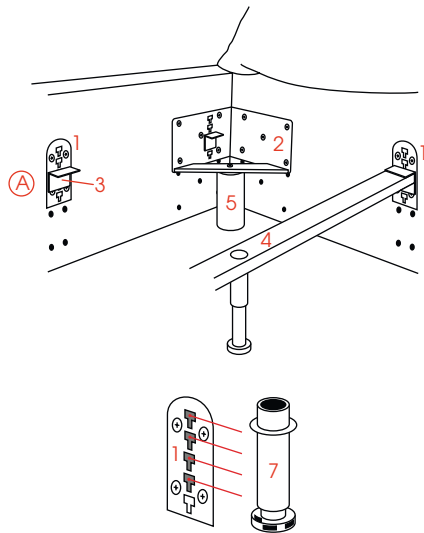

Slatted frame: the connectors (1) and corner angles (2) have to be mounted with the supplied screws at the upper hole position (A).

At any corner angle (2) screw in at screw threads M8 a 13 cm height wooden foot (5).

The support bracket (3) and the stabiliser bar (4) have to be connected at the same level.

When you have decided a height, press the suitable supporting foot tight into the stabiliser bar (4) and by turning, adjust the floor height.

The large supporting foot (7) can be used for all positions of slatted frames.

Detailed assembly instruction of box spring frames:

Insert depth for box spring frame = 21,5-31 cm

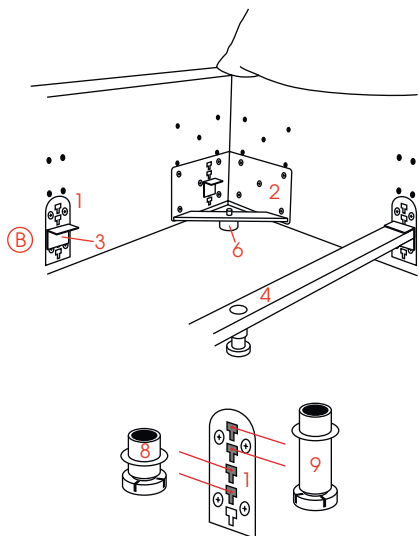

Box spring frame: the connectors (1) and corner angles (2) have to be mounted with the supplied screws at the lower hole position (B).

At any corner angle (2) a 2,5 cm height plastic glide feet (6) has to be plugged 12,5 mm into the bore.

The support bracket (3) and the stabiliser bar (4) have to be connected at the same level.

After you have decided a height, press the suitable supporting foot tight into the stabiliser bar (4) and by turning, adjust the floor height.

The small supporting foot (8) can be used for the 2 lower positions of box spring frames. The medium support foot can be used for the upper positions (9).

