

ASSEMBLY AND INSTRUCTION MANUAL

MODEL OD2308 BALOU

© 2023 KURT BEIER & KATI QUINGER



Functional backrest,
manually adjustable



Stool, usable as sofa element



Super soft sitting comfort

Use of back/armrest function:

Adjustment of back/armrest:

1. To adjust the desired position grip the back/armrest from the outside and pull it carefully into your direction.



2. To obtain zero position pull the back/armrest carefully beyond the top position into your direction (a) and fold down into zero position (b).



3. From the zero position, you can gradually adjust the back/armrest to the desired position.



Assembly/Transport protection:

ATTENTION! To ensure secure assembly, please observe the individual steps of instruction! The furniture **should** be mounted in pairs (2 persons)!

1. Position the packing unit at the place where supposed to be placed and open the packaging.



To avoid damaging the furniture/fabric, leave the leather strips on the hinges until assembly of back/armrest.

Assembly of back/armrest:



Remove the leather strips from the hinges.

To prevent the seat from being lifted, one person should sit on the seat.

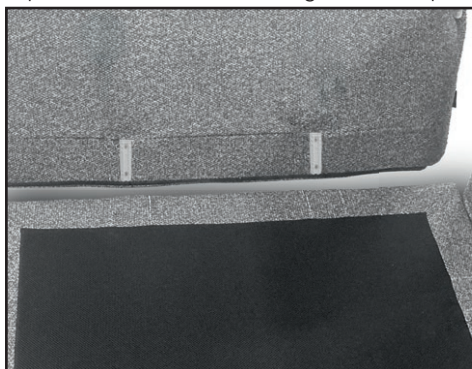

Back/armrest hinge



Seat hinge

Position the backrest/armrest hinges exactly above the seat hinges...

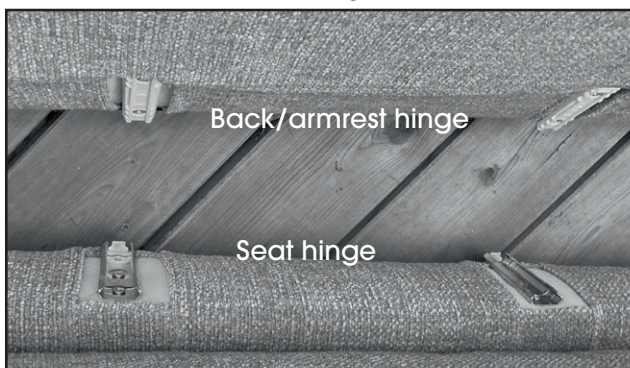

Back/armrest hinge

Seat hinge



Insert the seat cushion.

...and slide the backrest/armrest into the seat hinge from above.

Disassembly, Back/armrest:

To prevent the seat from being lifted, one person should sit on the seat.

To dismantle, stand behind the back/armrest and pull the back/armrest upwards out of the hinges with a gentle tug.

Connecting of elements:

Figure: 2 x elements 70T with stool 550

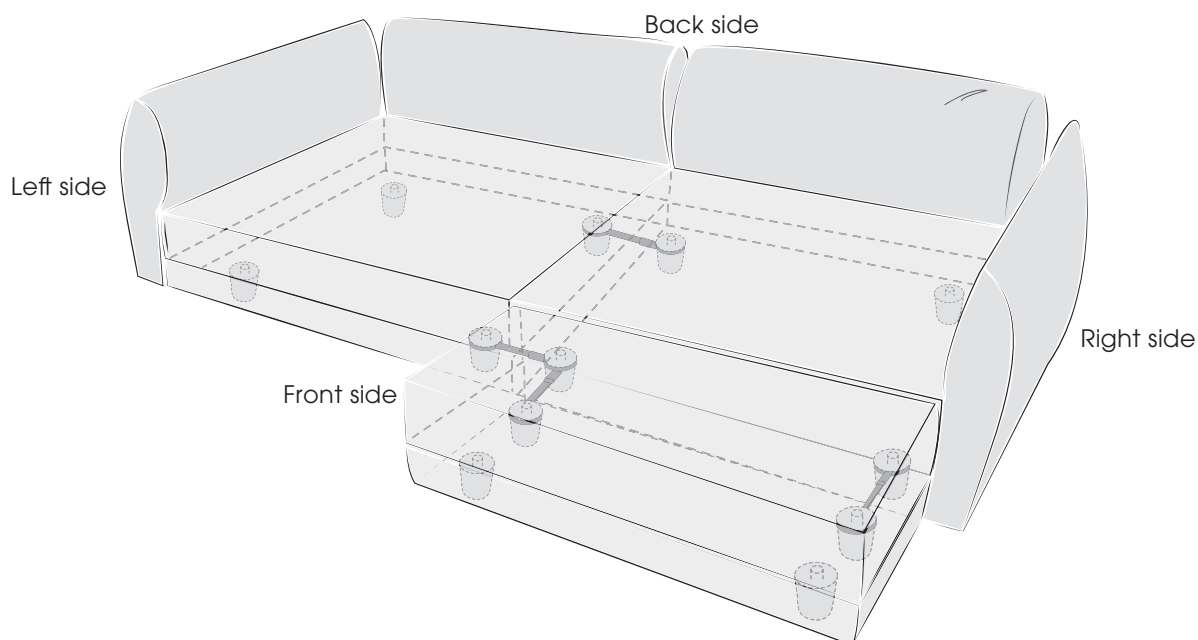

Example with 1 element + 1 stool:

1. Place the enclosed components in front of you!

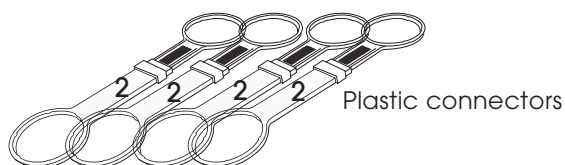

2. Lift up the element slightly, slide the plastic connectors (2) onto the plastic glides (1) from below and push them firmly upwards.

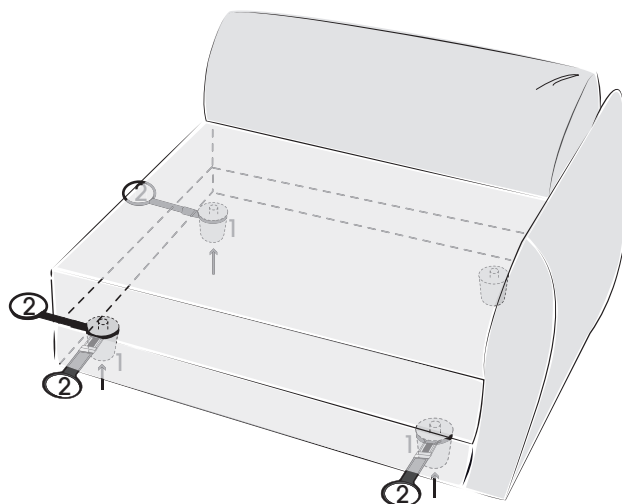
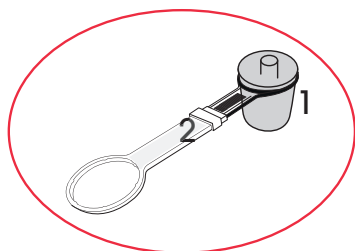

3. Place the stool in front of the plastic connectors and lift it from above into the circular opening of the plastic connectors.

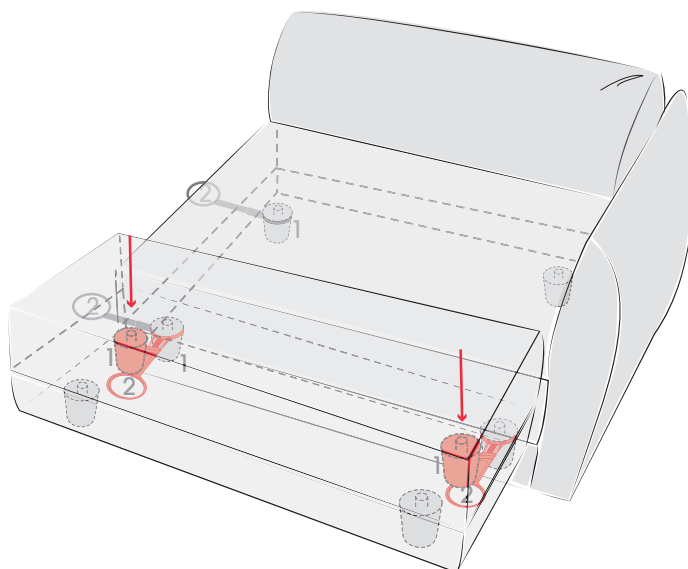
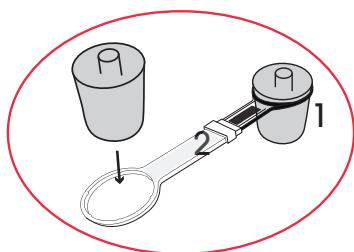

4. Press them upwards.

Repeat the process for all other connections.

